

Cal Poly SLO's Coastal Gardens Community

Homelessness is a growing problem in today's society. Many cities are struggling to find sustainable solutions to this problem. The City of ASCE, however, is coming up with its own solutions. The City is developing a new, sustainably-designed transitional housing community, named the Coastal Gardens Community, to provide homeless families with shelter and support, and help them regain financial stability.

Project Features:

- Ten sustainable tiny homes
- Community center
- Community garden
- Weather-resistant exercise equipment
- Support for multiple modes of transportation
- On-site renewable energy generation
- 100% on-site stormwater runoff containment

Source of Inspiration: Cal Poly Yakitutu Student Dorms



Bioswales for on-site stormwater containment



1 of 22 murals that reflect the flora and fauna found in San Luis Obispo

Elevation View



Goals:

- Create 10 tiny homes, each with a permanent address, to provide temporary residence for homeless families
- Give residents the opportunity to find employment in the City of ASCE and receive a salary
- Promote skill building and future success by holding educational classes in the community center
- Foster community between residents of the tiny home community
- Foster community and networking between residents and people living in the City of ASCE

Stormwater Strategies

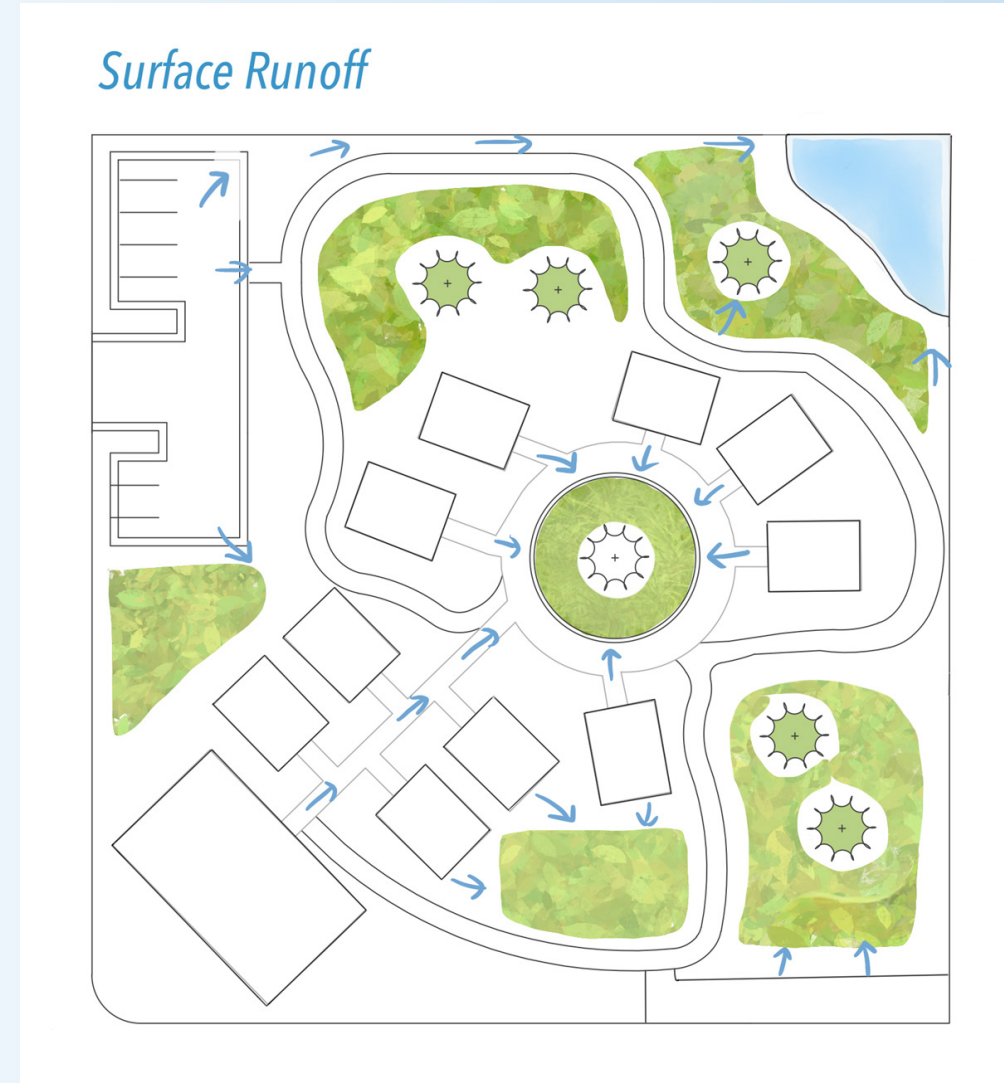

Stormwater runoff containment strategies:

- 100-gallon rain barrels capture runoff from building roofs and act as an irrigation source for
- Wetlands to capture all runoff from the parking lot



- Bioswales features:**
- native plants
 - rain gardens
- Community garden features:**
- Vegetables and fruits can help sustain residents
 - produce can be sold at a local farmer's market to help residents build connections outside the community.

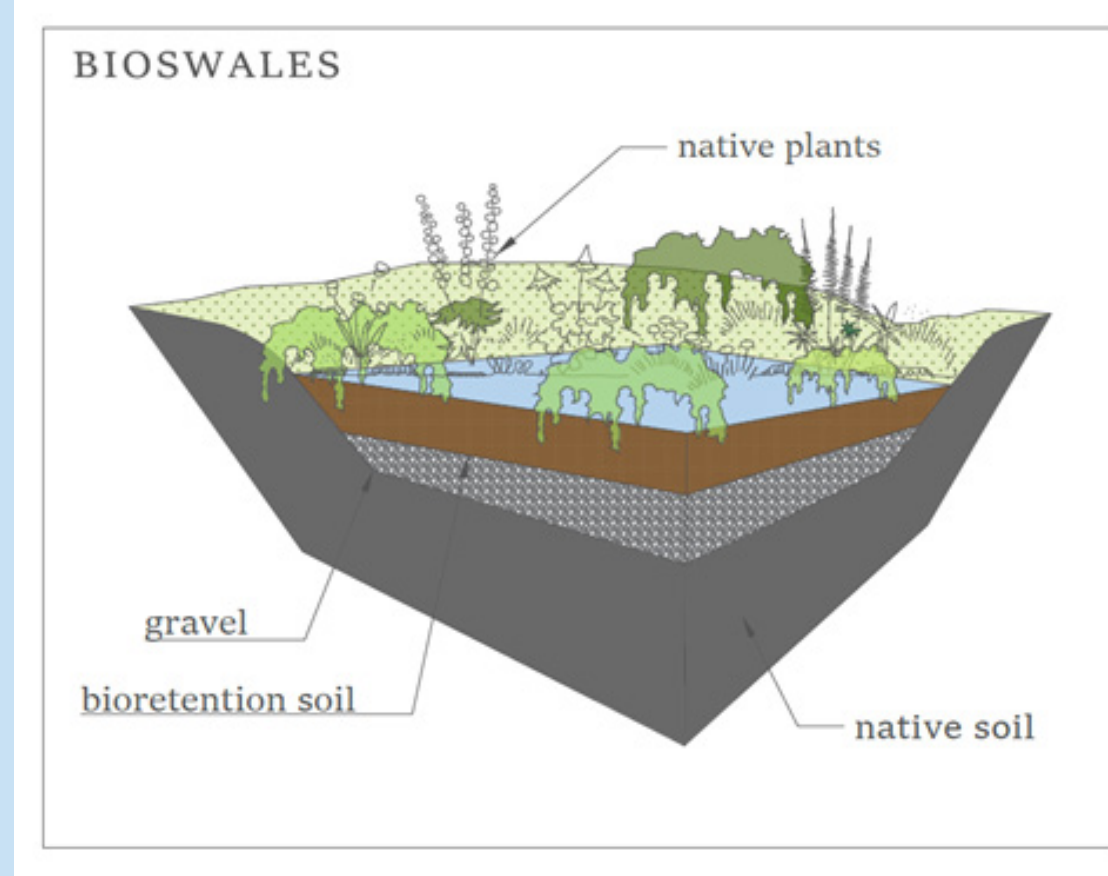

Community Activity Areas

A central courtyard encourages interaction between residents and has a turf lawn for small outdoor recreation.



Weather-resistant stationary equipment and open spaces provide ways for residents to improve their physical health

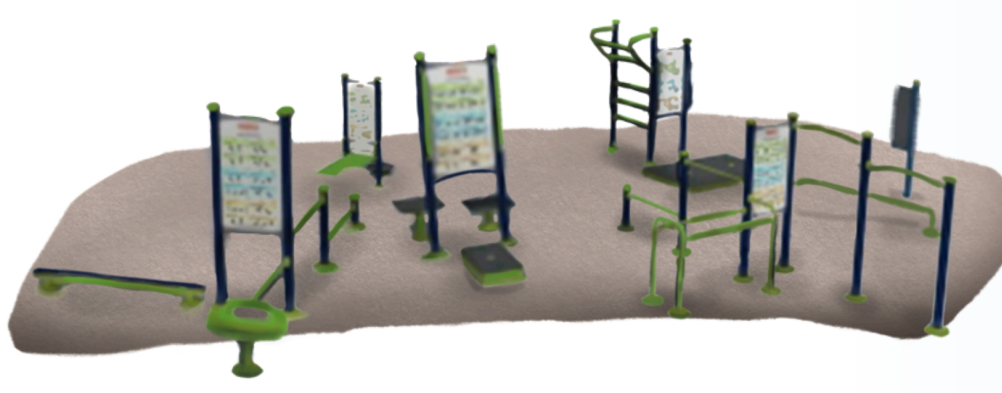

Multi-modal Transportation Solutions

A bus stop will be within walking distance of the site, and will be serviced by zero-emission buses to improve connections between residents and the greater community.



Multi-modal Transportation Solutions:

- Infrastructural support for ride-share services
- Bike racks and bike-share services

