

MAY 16-17, 2024

ISI ZOFNASS RESEARCH PROGRAM WORKSHOP

**Research Findings on
Sustainable Infrastructure
and Insights from Envision
Implementation**



DAY 1

9:00 am

Welcome and introduction

**Opening presentation: ZP Research
Program**

10:00 am

**Morning session:
The Envision Story of NYC: Agencies'
Experience with Implementation.**

12 pm – 1 pm

Lunch (available to all attendees)

1:00 pm

**Afternoon sessions:
The Cost and Benefits of Implementing
Envision**

2:45 pm

**NYC Projects Perspectives: The Cost and
Benefits of Implementing Envision**

4:45 pm

Conclusions and Charting Future Research

5:00 pm

Networking session

DAY 2

8:30 am – 5 pm (RSVP)

**Field Visits and Applied Learning Sessions
Envision Projects**

Join us in NYC!

ISI Zofnass Research Program Workshop:

Research Findings on Sustainable Infrastructure and Insights from Envision Implementation

May 16–17, 2024

Join us for the ISI Zofnass Research Program workshop in NYC, hosted by NV5, where you can learn and engage with recent findings on the implementation of sustainable infrastructure. This event offers a comprehensive examination of preliminary research outcomes and the application of the Envision framework by leading agencies and practitioners in the field and in New York City. The program is structured to facilitate a thorough understanding of the challenges and benefits associated with sustainable practices, featuring presentations from New York City's leading agencies. This workshop is aimed at sustainability professionals and stakeholders in the infrastructure sector. The workshop promises a thoughtful exchange of knowledge and a collaborative vision for the future of sustainable development.

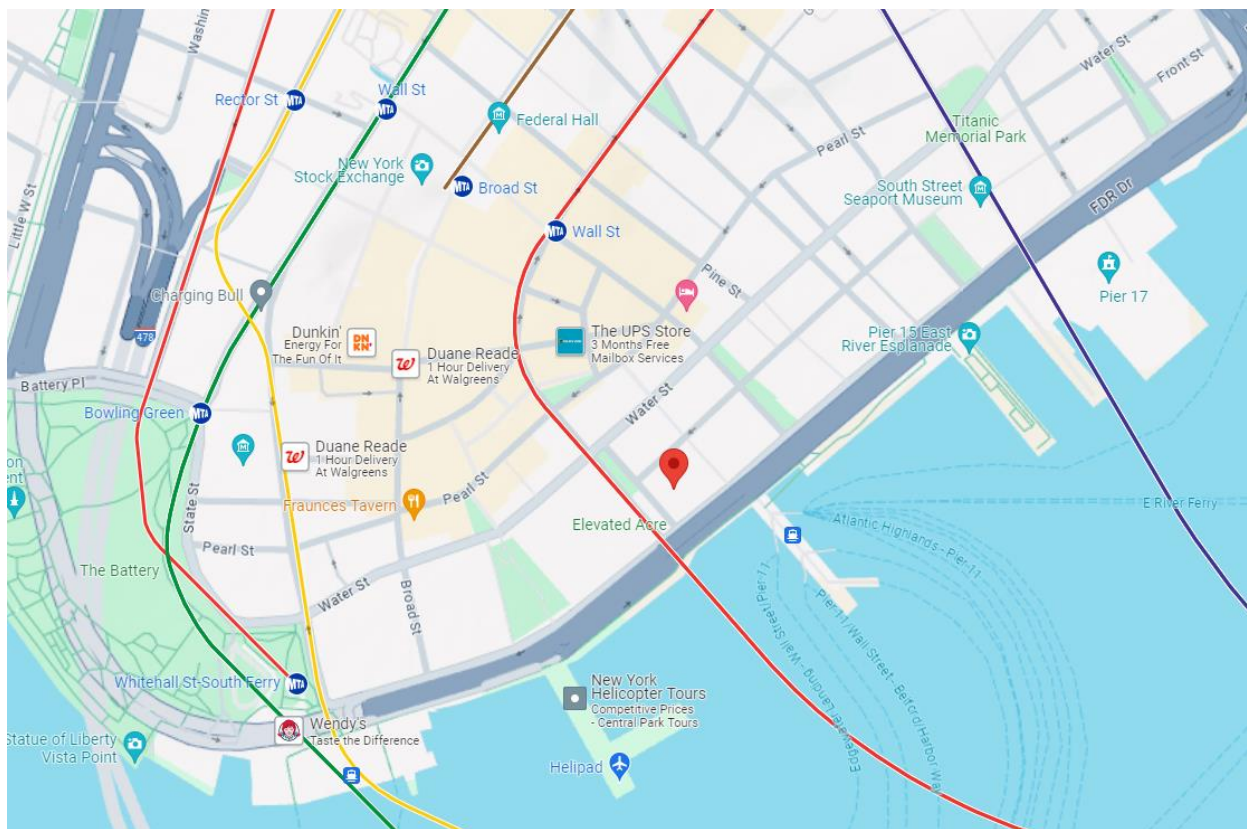

Location: 32 Old Slip (Second Floor), New York City

Attire: Business casual

Registration link: <https://ISIWorkshopMay.eventbrite.com>

Workshop main contact: Judith Rodriguez, rodriguez@sustainableinfrastructure.org

Agenda Day 1

May 16, 2024

8:30 am Coffee and breakfast items available.

9:00 am

Welcome and introduction to ISI Workshop

Anthony Kane, *President & CEO, ISI*

Judith Rodríguez, *Sr. Research Associate, ISI*

Envision at NV5

Ashley Metius, ENV SP, WEDG, Senior Environmental Specialist, NV5

Matthew Nayer, PE, ENV SP, Director of Civil Engineering, NV5

The Zofnass Research Program

Introduction to the ZP Research program, research, and updates on relevant publications.

Prof. Spiro Pollalis, *Sr. Research Fellow at ISI and Professor Emeritus at Harvard University*

Q&A

9:45 am: Refreshment break

10:00 am

Morning session:

The Envision Story of NYC: Agencies' Experience with Implementation.

A series of presentations from city agencies MTA, NYC DDC, NYC CEDC, NYC Parks, and PANYNJ, detailing their experiences and insights in adopting the Envision framework. Followed by an engaging moderated panel discussion with agency representatives, Envision users, and the audience.

Moderated by:

Kailey Eldredge, Senior Verification Specialist, ISI

Matthew Nayer, Director of Civil Engineering, NV5

NYC Department of Design and Construction (NYC DDC)

Sofia Zuberbuhler-Yafar, RLA, ENV SP, Infrastructure I Assistant Commissioner, Sustainability & Urban Design, NYC DDC

Scott Makosiej, RLA, ENV SP, Director, Infrastructure, Design, Landscape, NYC DDC

Sustainable Infrastructure for Mass Transit. Metropolitan Transportation Authority, (MTA)

Thomas Abdallah, P.E. LEED AP, ENV SP, Vice President Environmental Services and Chief Environmental Engineer, MTA C&D

Thomas will discuss the sustainable initiatives included in MTA past and present capital construction infrastructure projects and discuss proposed future Envision verified projects that MTA C&D is currently attempting. Mass Transit is the most sustainable solution for cities to combat the effects of global climate change, limit pollution, and reduce the use of fossil fuels. One thing that anyone can do to contribute to a more sustainable world is to take Mass Transit, which helps the world by reducing emissions that pollute the air and increase the greenhouse gases in the atmosphere. Mass transit does have its own carbon footprint, and the past two and a half decades MTA has included sustainable elements to reduce greenhouse gases and toxic pollution.

The Port Authority of New York & New Jersey (PANYNJ)

Melissa Targett, Senior Program Manager, Sustainable Design & Construction, PANYNJ

PANYNJ will present their approach to implementing Envision through the Agency's Sustainable Infrastructure Guidelines. The presentation will describe the history of sustainable design at the Agency, an overview of the guidelines as well as present the specific tools developed to support sustainable infrastructure implementation in NYC.

New York City Parks (NYC Parks) and New York City Economic Development Corporation (NYC EDC)

Grace Tang, Program Director, NYC Parks

Jennifer Cass, PE, LEED AP, Senior Vice-President, Sustainability and Resilience, Capital Program, NYC EDC

Moderated discussion

12 pm – 1 pm

LUNCH BREAK: Farm-to-Table lunch from *Green Top Farms* for all attendees in the dining area.

1:00 pm – 2:30 pm

Afternoon sessions:

The Cost and Benefits of Implementing Envision.

Presentation of the ongoing research survey on verified projects and preliminary findings. Interactive session with live polling with the participation of the audience.

Anthony Kane, *President & CEO, ISI*

Judith Rodríguez, *Senior Research Associate, ISI*

Ted Marcelo, *Senior Learning Technologist, ISI*

Preliminary Results of the Envision User Survey: Understanding Costs and Benefits

Uncertainty about the cost of sustainability and third-party verification is a leading barrier for project sponsors. This survey, developed by ISI's Zofnass Research Program, will shed light on the financial implications and benefits of implementing Envision criteria on infrastructure projects as well as the time and costs associated with Envision verification. The survey is only offered to project teams involved in an Envision-verified project. The survey consists of 59 questions divided into two parts.

Part 1: Implementation Costs and Benefits

Evaluating costs and benefits of implementing Envision credits

Evaluating Benefits

Learned Lessons and Best Practices

Part 2: Verification Costs and Benefits

Evaluating the time and effort of Envision Verification

Evaluating the cost and benefits of Envision Verification

2:30 pm *Short coffee break*

2:45 pm

NYC Project Perspectives: The Cost and Benefits of Implementing Envision

In-depth project-based presentations in preparation for the field trip, prioritizing NYC projects, and sharing insights on implementing Envision and challenges faced.

Moderated by **Kristi Wamstad**, Verification Director, ISI.

Forensic application of Envision: Broad Channel and Starlight Park

Matthew Nayer, PE, ENV SP, Director of Civil Engineering, NV5

Ashley Metius, ENV SP, WEDG, Senior Environmental Specialist, NV5

Sofia Zuberbuhler-Yafar RLA, ENV SP, Infrastructure I Assistant Commissioner, Sustainability & Urban Design, NYC Department of Design and Construction

Lower Manhattan Coastal Resilience – The Battery

Brad Moore, P.Eng., ALM, ENV SP, Sustainable Infrastructure Team Lead. Stantec

Ethan Smith, ENV SP, LEED GA, WEDG, GIT, Project Manager, Hunter Roberts Construction Group

In this session, Brad Moore of Stantec and Ethan Smith of Hunter Roberts Construction Group, will provide an overview of how the Lower Manhattan Coastal Resiliency – The Battery project was able to develop a design that will accommodate for future sea level rise, while reducing the net embodied carbon of the project. Brad and Ethan will share perspectives on how to translate embodied carbon reduction goals into results through analysis, procurement, and construction.

East Side Coastal Resiliency (ESCR) Project

Matthew T. Potter, AIA, ENV SP, LEED AP BD+C, NCARB, WEDG, Senior Project Architect, Northeast Division Architecture, HNTB Corporation

The East Side Coastal Resiliency (ESCR) Project is a coastal protection initiative, jointly funded by the City of New York and the federal government, aimed at reducing flood risk due to coastal storms and sea level rise on Manhattan's East Side from East 25th Street to Montgomery Street. The ESCR Project is a priority of the City of New York as outlined in the 2015 "One New York: The Plan for a Strong and Just City" and by the innovative "Rebuild by Design" competition sponsored by the U.S. Department of Housing and Urban Development (HUD). The project design intends to integrate flood protection into the community fabric, improving access to the waterfront rather than walling off the neighborhood. Since early visioning, the City has been working hand-in-hand with community partners and residents to identify the best ways to meet the challenges we face from climate change, including sea level rise and more frequent, intense storms. Once complete, the ESCR Project will provide improved coastal protection to more than 110,000 vulnerable New Yorkers through 2.4 miles of enhanced waterfront, ecology, and urban spaces. The project has been awarded the Envision Gold Award in the Summer of 2022.

MTA: Times Square Shuttle

Yekaterina (Kate) Aglitsky, LEED AP, ENV SP, Environmental Management system & Sustainability Director, MTA C&D

Kate will discuss MTA C&D's ongoing efforts to complete their first Envision verified project the Times Square Shuttle. The Times Square shuttle is a dedicated train that connects two of New York City's most iconic subway stations together: Times Square Station and Grand Central Station. It is a critical connection in the overall MTA New York City Transit operating system. Most recently it has been rehabilitated to become a more functional connector that bridges the gap between the east side of Manhattan and mid-town.

Bayonne Bridge Navigational Clearance Project

Melissa Targett, Senior Program Manager, Sustainable Design & Construction, PANYNJ

Applying Envision Retroactively – PANYNJ’s experience with the Bayonne Bridge Navigational Clearance Project. Presentation will demonstrate how to leverage existing processes to meet requirements for Envision documentation as well as provide a deeper dive into the Envision credit Reduce Net Embodied Carbon.

Moderated Q&A

4:30 pm *Short break*

4:45 pm

Conclusions and Wrap-up

Anthony Kane, President & CEO, ISI

5:00 pm – 6:00 pm

Networking session

Location: Suite 401 NV5

Join us for a relaxed networking event with an optional tour of the NV5 office. Appetizers and drinks available.

Agenda Day 2

May 17, 2024

8:30 am – 5 pm

Field Visits and Applied Learning Sessions at Envision Projects

Guided visits to Envision projects showcasing the implementation in the field. The bus has a 56-person capacity, RSVP by emailing: rodriguez@sustainableinfrastructure.org

If RSVPs are complete, you can still join us for visit 1 and meet us later at Starlight Park at 3 pm, you can take public transit or an alternative bike route if you prefer an active exploration.

Field trip itinerary:

Note: All ETAs are estimated and traffic-dependent. The bus departure times may change depending on the completion of the guided visits.

Attire: For comfort and safety, please wear comfortable clothing and closed-toe shoes. Additionally, if you own personal protective equipment (PPE) such as a hard hat, we recommend bringing it along.

8:00 am – Optional pick-up at 32 Old Slip, NYC

- Board the bus for a brief short ride to our meeting point.

8:20 am - 8:30 am– Meeting point location at Battery Park.

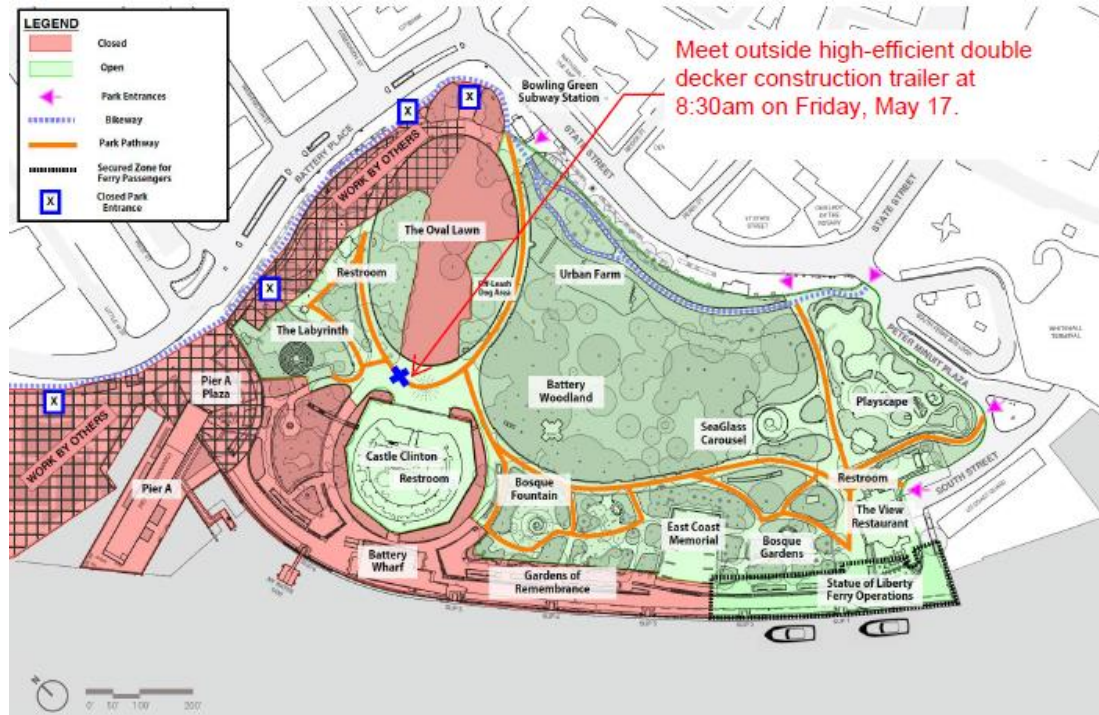

Visit 1: Lower Manhattan Coastal Resiliency – The Battery Park

8:20 am to 8:30 am - Attendees gather at the designated meeting point.

8:30 am Guided visit starts. Guided tour to publicly accessible areas by Hunter Roberts Construction Group and Stantec. (30-minute visit).

Guided visit by:

Brad Moore, P.Eng., ALM, ENV SP, Sustainable Infrastructure Team Lead. Stantec
Ethan Smith, ENV SP, LEED GA, WEDG, GIT, Project Manager, Hunter Roberts Construction Group

9:10 am - Departure to next project. Board the bus for a brief 5-minute ride via FDR Drive.

Visit 2: East Side Coastal Resiliency (ESCR) project

9:25 am - Guided visit ETA. Guided visit by NYC DDC from Asser Levy Park to Stuey Cove (30-minute visit).

Guided visit by:

Dhanraj Damri (Damri), Deputy Director-ESCR, NYC DDC.

Leah Wener, RLA, WEDG, Project Manager/Landscape Architect, HNTB

10:00 am - Departure to next project. Board the bus for a 25-minute ride via FDR Drive.

Visit 3: MTA Shuttle Times Square

10:25 am – ETA. Guided visit by MTA (30-minute visit).

Guided visit by **Yekaterina (Kate) Aglitsky**, LEED AP, ENV SP , Environmental Management system & Sustainability Director, MTA C&D

11:00 am - Departure to next project. Board the bus for a 1-hour 10 minutes ride via Cross Bay Blvd and I-495 W

Trivia: Enjoy some trivia on projects and Envision on the ride!

Visit 4: Broad Channel, Queens

12:10 pm – ETA. Guided visit by NV5 (20-minute visit)

Guided visit by:

Matthew Nayer, PE, ENV SP, Director of Civil Engineering, NV5

Ashley Metius, ENV SP, WEDG, Senior Environmental Specialist, NV5

12:30 pm LUNCH BREAK. Bagged lunch for all attendees in the natural areas nearby.

1:00 pm - Departure to next project. Board the bus for a 1-hour ride via Grand Central Pkwy.

Trivia: Enjoy some trivia on projects and Envision on the ride!

Visit 5: Starlight Park, Bronx

3:10 pm – ETA. Guided visit by NV5 (1-hour visit). This is our final guided visit.

Guided visit by:

Matthew Nayer, PE, ENV SP, Director of Civil Engineering, NV5

Ashley Metius, ENV SP, WEDG, Senior Environmental Specialist, NV5

Snacks will be available to all attendees.

4:30 pm – Departure, optional happy hour, and end of bus tour. Board the bus for an optional drop-off at a local brewery, and remain on the bus for a 31-minute ride via FDR Dr to 32 Old Slip near Wall Street.

4:40 pm ETA drop-off OPTION at Bronx Brewery. Join us for happy hour at a local brewery. Note: Brewery drinks, food, and return travel costs on your own.

5:00 pm ETA final drop-off at 32 Old Slip, NYC. End of field trip.

BIOS

(In alphabetical order)



Thomas Abdallah, P.E. LEED AP, ENV SP

Vice President Environmental Services and Chief Environmental Engineer, MTA C&D

Thomas Abdallah, P.E. LEED AP, ENV SP is the Vice President Environmental Services and Chief Environmental Engineer for the MTA's Construction and Development (MTA C&D) agency. Thomas holds a B.S. in Chemical Engineering from Rutgers University. Thomas is also an Adjunct Professor at Columbia University in the Sustainability Management graduate program. As Chief Environmental Engineer he is responsible to provide expert environmental engineering services for all MTA capital projects and ensures that all design and construction projects meet environmental requirements including the National Environmental Policy Act and the NY State Environmental Quality Review Act. Thomas Abdallah is the author of the 1st & 2nd Edition of Sustainable Mass Transit: Challenges and Opportunities in Urban Public Transportation. Thomas has appeared on Discovery Channel, PBS, NPR, numerous environmental podcasts, and appeared in an episode of History Channel's Modern Marvels – Moving America.



Yekaterina (Kate) Aglitsky, LEED AP, ENV SP

Environmental Management system & Sustainability Director, MTA C&D

Kate Aglitsky, LEED AP, ENV SP From environmental activism of her student years to becoming a Director of ISO 14001 Certified Environmental Management System, LEED® Accredited Professional, Envision Specialist and certified Envision Trainer. Kate carries her passion for the environment. She spent more than a dozen years in the fields of “reactive” environmentalism: asbestos, lead, radon, radiation, subsurface investigation, Phase I/II, mold, SEQRA, EAs, EISs, industrial hygiene, compliance work, hazard abatement etc. in both private and public sectors. In 2006 she accepted the challenge of bringing “proactive” environmentalism into the design and construction work at New York City Transit, and she carries on with continual improvement of the EMS, promoting LEED® and Envision Rating systems, and drafting “green transit” guidelines in cooperation with national and international entities (TRB, APTA, UITP, NOVA, CoMet etc.). The first NYCT LEED Gold certified bus maintenance facility was a success due, in part, to Kate's efforts. Kate is also an adjunct professor at Stevens Institute of Technology.



Jennifer Cass, PE, LEED AP

Senior Vice-President, Sustainability and Resilience, Capital Program, NYC EDC

Jennifer Cass is the Senior Vice President of Sustainability and Resilience of the Capital Program of the New York City Economic Development Corporation where she leads a diverse portfolio of projects that enhance NYC communities. She holds a Bachelor's Degree in Environmental Engineering from Rensselaer Polytechnic Institute and is a licensed professional engineer in New York and California. Ms. Cass has

a mission to drive economic and sustainable growth in the great City of New York. With over 20 years of experience in the public and private engineering sector, she specializes in the sustainable and resilient design and construction of large complex infrastructure projects such as NYC Ferry, UN Esplanade, and the Clean and Circular Construction program.



Dhanraj Damri

Deputy Director, DDC Construction, Coastal Resiliency

+20 years with NYC DDC

Project Manager managing the construction of Coastal Resiliency Projects from construction inception, October 2020.



Scott Makosiej, RLA, ENV SP

Director, Infrastructure, Design, Landscape, NYC DDC

Scott Makosiej, RLA, ENV SP is the Director of Landscape and Urban Design in the Infrastructure division at the NYC Department of Design and Construction (DDC). A lifelong New Yorker, Scott has over 23 years of public service experience in design and project management beginning at the New York City Housing Authority (NYCHA) and in various roles at DDC leading up to his current position. As Director, he ensures the Agency Blueprint goals are met and sustainable, equitable, and resilient lenses are included in the designs to support an ever-changing and evolving New York City. Scott earned his Bachelor of Science in Landscape Architecture from the University of Massachusetts at Amherst where he graduated with Cum Laude honors.



Ashley Metius, ENV SP, WEDG

Senior Environmental Specialist, NV5

Ashley Metius leads the sustainability group of the NV5 New York City office. She has currently applied the ISI Envision framework to five large scale NYC capital infrastructure projects including Starlight Park (Gold award), Broad Channel (Verified award), and East Side Coastal Resiliency (Gold award). Her background is in environmental science, and she previously served the City of New York as a project manager in ecological services and for the Bluebelt Program. Ashley is an active member of the Sustainable Infrastructure Advisory Board and the Jersey City Environmental Commission.



Brad Moore, P.Eng., ENV SP

Sustainable Infrastructure Team Lead, Stantec Consulting

Brad is a Civil Engineer specializing in the field of sustainable infrastructure design with Stantec Consulting and a graduate of Harvard University's ALM in Sustainability program. In his career, Brad has applied his unique skill set to

projects at over 70 locations across North America including the design of transit facilities, ports, parks, wastewater facilities, water distribution, stormwater management, and major roadways. Brad is currently guiding over \$12 Billion (construction value) in infrastructure projects through the Envision™ process that seeks to improve the sustainability and resilience of our infrastructure.



Matthew Nayer, P.Eng., ENV SP, WEDG

Director of Civil Engineering, NV5

As Director of Civil Engineering, Matthew Nayer, oversees NV5's talented group of civil engineers to continue delivering practical, sustainable, and innovative solutions for infrastructure improvements sought by both public and private clients throughout New York City. Matt has been with NV5 for 15 years, working primarily on transportation projects, including roadway/geometric design, drainage design, site/civil design, utility engineering, and construction support services. He has played a critical role in many of NV5's high-profile infrastructure projects, like Red Hook Coastal Resiliency. Throughout his career, he has exhibited great leadership, while consistently growing his body of work and areas of expertise. He is an active member in the American Society of Civil Engineers and is certified both as an Envision Sustainability Professional and in Waterfront Edge Design Guidelines.



Matthew T. Potter, AIA, ENV SP, LEED AP BD+C, NCARB, WEDG

Senior Project Architect, Northeast Division Architecture, HNTB Corporation

Matthew is a registered architect and sustainability professional with more than 14 years of professional experience. He has extensive experience in architectural design, project management, planning, and sustainability framework systems, such as Envision, LEED, and WEDG. Matthew has lectured and participated in panels on the Envision Framework Rating System at the AIA Center for Architecture in New York; the Institute for Sustainable Infrastructure in Washington, D.C.; the Zofnass Program at Harvard University. He has worked on transportation, public, and master planning projects, many of which have been published internationally.



Ethan Smith, ENV SP, LEED GA, WEDG, GIT

Project Manager, Hunter Roberts Construction Group

In his role at Hunter Roberts, Ethan manages the Battery Coastal Resilience Project, which is one of several projects together known as the Lower Manhattan Coastal Resiliency (LMCR) Project, an integrated coastal protection initiative to reduce flood risk from storms and sea-level rise in Lower Manhattan. Ethan oversees the project's budget and schedule, implements cost controls, ensures conformance to design documents, and communicates progress to various stakeholders. Ethan is the Envision lead for the construction team and is responsible to ensure sustainable processes are implemented throughout construction and all related efforts are adequately documented to conform with Envision Credit requirements. Ethan holds a bachelor's degree in geosciences from SUNY New Paltz and is completing his master's degree in environmental geology at Rutgers. He began his career in engineering at firms including LiRo and

Langan before pivoting to resilience-focused construction management. Ethan developed an appreciation for the water while growing up on Long Island and always wanted to pursue a career that helped ensure marine and coastal environments could last for generations to come.



Greg Sprich, P.Eng., ENV SP

Principal, Stantec Consulting

Over a 16-year career, Greg has managed a multitude of large scale, complex infrastructure projects, including transit developments, waterfront structures, parks, streetscapes, and plazas. Greg believes that these projects must service the communities in which they are built and be both resilient and sustainable. As a project manager, Greg is known as a trusted advisor for both project teams and clients, and is passionate about strategically evaluating how pieces of projects fit together while not losing sight of the long-term objectives.



Grace Tang

Program Director, NYC Parks

Grace Tang, Program Director at NYC Parks, manages climate resiliency initiatives across all 5 boroughs, including the Lower Manhattan Coastal Resiliency (LMCR) Battery project, which is one part of a series of projects to build resilience Lower Manhattan. Grace was also a contributor to the publication *Designing and Planning for Flood Resiliency: Guidelines for NYC Parks*. Trained as a landscape architect and engineer, Grace has dedicated her career to the planning, design, and construction of complex urban parks and open spaces. She holds a Masters of Landscape Architecture from the University of Toronto and Bachelor of Science from Queen's University.



Leah Wener, RLA, WEDG

Project Manager/Landscape Architect, HNTB

Leah Wener, RLA WEDG is a licensed landscape architect with expertise in public space planning, design, construction, maintenance and management. She has worked as a designer at public agencies, non-profit organizations, and engineering firms and her project portfolio encompasses the design of expansive urban plazas, ecologically sensitive woodlands, park playgrounds, and street-end rain gardens. As a member of the Project Management and Construction Management team for the East Side Coastal Resiliency project (ESCR) since the pre-construction phase, Leah has led coordination on landscape construction, environmental compliance, and community outreach. She is supporting the ongoing Envision documentation process through construction.



Sofía Zuberbühler-Yafar, RLA, ENV SP

Infrastructure | Assistant Commissioner, Sustainability & Urban Design, NYC DDC

Sofía Zuberbühler-Yafar, RLA, ENV SP is a registered Landscape Architect with a master's in urban design and has over 24 years of varied experience with the planning, design and management of public/private built environment projects. Presently, Sofía is Assistant Commissioner of Sustainability & Urban Design at the NYC Department of Design and Construction. She leads the Infrastructure Division's integration of climate readiness, sustainability, and equity. In addition, she oversees multimillion dollar green infrastructure and cloudburst management capital design contracts. Sofía is on the Envision Review Board with the Institute for Sustainable Infrastructure and is part of several other NYC sustainability task forces. She is a double alumna of the CCNY School of Architecture and of the Fontainebleau School of Architecture & Fine Arts, Summer 2001 session.

ISI Team

(In alphabetical order)



Leslie Brunell, PhD, P.E., F.ASCE, ENV SP

Education Director, ISI

Leslie Brunell is the Director of Education at ISI. She oversees educational programming including the Envision Sustainability Professional credential, continuing education courses, and training for Envision Verifiers and ISI trainers. She was formerly a Teaching Professor in the Department of Civil, Environmental and Ocean Engineering at Stevens Institute of Technology. She served as a member, and Chair, of the Academic Committee for ISI. This committee works to increase the Envision resources for academic use at universities and colleges.

Leslie is a registered Professional Engineer in the state of NJ, and an ASCE Fellow. She has been honored as Educator of the Year by both the New Jersey and North Jersey Chapters of the ASCE and was recognized by the New Jersey Inventors Hall of Fame for Advancement of Invention and Process.

Leslie received her BE, ME and PhD from Stevens Institute of Technology. She worked as a Water Resources Engineer for over 14 years before transitioning to academia.



Kailey Eldredge, ENV SP, LEED AP BD+C

Senior Verification Specialist, ISI

Kailey is the Senior Verification specialist at ISI.

In addition to providing technical assistance and aiding program implementation, she is responsible for leading projects through the Envision verification process.

Prior to joining ISI, she was a senior sustainability consultant at C&S Companies, where she grew a nationally recognized practice— focused on integrating sustainability and resilience into airport processes and projects.

Kailey holds a bachelor’s degree from Cornell University, where she majored in environmental studies. Her concentration was in city and regional planning. Kailey lives in Chicago, Illinois, with her husband and dog, Bagel.



Anthony Kane, ENV SP

President & CEO, ISI

Anthony Kane is President & CEO of the Institute for Sustainable Infrastructure in Washington, DC where he oversees the organization’s overall operations and leads the development of the Envision framework for sustainable infrastructure.

He is also a commissioner on the Washington DC Commission on Climate Change and Resiliency. Anthony was formerly a research director at the Zofnass Program for Sustainable Infrastructure at Harvard University’s Graduate School of Design, a research associate with the Materials, Processes, and Systems Group at Harvard University, and an instructor at the Boston Architectural College. He holds a Bachelor of Architecture summa cum laude from Virginia Tech and a Master in Design Studies from Harvard University. Anthony is a co-author of Ceramic Material Systems in Architecture and Interior Design and a contributing author of Infrastructure Sustainability and Design.



Ted Marcelo, ENV SP

Senior Learning Technologist, ISI

Ted Marcelo is ISI’s Senior Learning Technologist, creating and advising on eLearning courses and instructor-led trainings through a variety of multimedia technologies. Ted holds a bachelor’s degree in English from the University of South Florida, and a master’s degree in instructional design & technology from

the University of Tampa.

Ted previously worked as the lead instructional designer and learning management system administrator for a wine and spirits distribution company in Miami. Prior to that, he worked as a counselor for a Tampa nonprofit, where he helped middle—and high-school students ideate and realize their post-secondary aspirations. He is an advocate for the reach that decentralized learning carries, particularly when impacting underserved communities. In his free time, he is either reading, writing, or enjoying sunny Florida.



Prof. Spiro Pollalis, Ph.D., M.B.A.

Sr. Research Fellow, Zofnass Research Program, ISI

Professor of Design, Technology, and Management, Emeritus, Harvard University

Prof. Pollalis has been a Professor of Design, Technology, and Management at the Harvard Design School for 36 years from 1986 to 2022. In 2022, he became Emeritus and is pursuing full-time research and private practice on sustainability and large-scale development.

At Harvard University, he was the Principal Investigator of the “Zofnass Program for the Sustainability of Infrastructure,” which initiated the development of Envision®. Based on Envision®, Prof. Pollalis and the researchers of the Zofnass Program have developed the Planning Guidelines for Sustainable Cities. Currently, Prof. Pollalis is a Senior Research Fellow at the Zofnass Research Program, housed at the Institute for Sustainable Infrastructure.

In his private practice through Prof.Dr.SN Pollalis, Inc., Prof. Pollalis has been a US General Services Administration (GSA) contractor for more than 25 years. He is the chief planner for the new sustainable DHA City Karachi for 600,000 people, the master of the redevelopment of the former Athens airport, and the developer’s advisor for the new Saudi economic city in the East Province. All of Prof. Pollalis’s projects center on sustainability.

Prof. Pollalis has consulted the World Bank, the UNEP, the UNECE, and the National Research Council of Canada. He has developed the National Urban Assessments for Pakistan and Kyrgyzstan for the Asian Development Bank.

Prof. Pollalis’s most recent books are: “Planning Sustainable Cities: An Infrastructure-based Approach,” published in 2016 by Routledge and “Gulf Sustainable Urbanism” in 2018 by HBKU Press. His new book on “Climate and Biodiversity” is on contract with Routledge, due in 2024.

Prof. Pollalis received his first degree from the University in Athens (EMP, 1977) and his Master’s and Ph.D. degrees from MIT (1979, 1982). His MBA degree in high technology was received from Northeastern University (1985). He has an honorary Master’s in Architecture from Harvard (1994).



Judith Rodríguez, ENV SP, LEED AP

Sr. Research Associate, Zofnass Research Program, Institute for Sustainable Infrastructure

As the Senior Research Associate at ISI, Judith is responsible for advancing research and tools for sustainable infrastructure and in support of the Envision sustainability framework.

She is a researcher and designer with domain expertise in sustainability standards, tools, and training. Her work experience as part of the Zofnass Program at Harvard University encompassed large-scale infrastructure assessments, tools development, best practices, vulnerability mapping, and risk reduction. She has extensive strong experience evaluating the sustainability, and climate resilience of infrastructure, contributing to the guidance of more than 60 diverse assets worth more than 20 billion USD. Judith coordinated more than 25 workshops at Harvard that brought together global industry leaders and specialists in sustainable infrastructure. She has taught courses on sustainable

infrastructure and global development practice with focus on achieving the Sustainable Development Goals (SDGs) and combating climate change.

Judith practiced as a designer in award-winning designs by Toyo Ito & Associates Architects in Tokyo, Skimmore, Owings & Merrill (SOM) in Chicago, Topotek 1 in Berlin, and LCLA Office. She holds master's degrees in landscape architecture and urban design from the Harvard University Graduate School of Design, in architecture from Illinois Institute of Technology, and a bachelor's in environmental design from the University of Puerto Rico.



Rebecca Tubito

Communications Specialist, ISI

Rebecca brings a decade of marketing experience to ISI, coupled with a passion for sustainability. Previously, she spent five years with a not-for-profit focused on food system sustainability, where she supported everything from branding and strategy to external communications, event planning and partnership development. She has led several sustainability groups throughout her career and has experience working with other sustainability frameworks like LEED, Living Building Challenge and B-Corp.

Rebecca has an MBA in marketing and sustainability from Rollins College in Winter Park, Florida and a bachelor's degree in economics and sociology from Emory University in Atlanta, Georgia. She has been recognized and received awards for her achievements in academia, leadership and entrepreneurship. Originally from Orlando, Florida, she now lives in Tallahassee, Florida with her husband and their two dogs.



Kristi Wamstad, ENV SP, LEED AP

Verification Director, ISI

Kristi Wamstad is the Envision Verification director at ISI. In this role, Kristi maintains the verification process, ensures consistency in project reviews, and provides technical assistance.

Prior to ISI, Kristi was the technical director for USGBC's LEED for Cities and Communities and STAR Communities, a comprehensive sustainability rating system for jurisdictions. Additional experience includes being sustainability coordinator for the city of Omaha and sustainable solutions program coordinator at HDR. In 2005, Kristi worked with the Oregon Bridge Delivery Partners to develop the Context Sensitive and Sustainable Solutions (CS3) program, a first-of-its-kind framework for applying sustainability to transportation infrastructure.

Kristi holds a master's degree in community and regional planning from the University of Nebraska-Lincoln and bachelors' degrees in biology and environmental science from the University of Colorado-Boulder. She lives in Lincoln, Nebraska, where she enjoys biking, gardening, and spending time with her kids, cats, guinea pigs, and chickens.